

FLOORPLAN SKETCH

Borrower: \_\_\_\_\_ File No.: LC1016SallyAnn  
Property Address: 2939 Sally Ann Dr Case No.: \_\_\_\_\_  
City: Fort Collins State: CO Zip: 80537  
Lender Agent: Stephanie Kirkland

Scope of Work is on our website  
www.appraisaldimensions.com  
© Copyright  
10/24/2016

2939 Sally Ann Dr  
Loveland, CO  
Total Sq Ft: 2041  
Total Finished Sq Ft: 2041

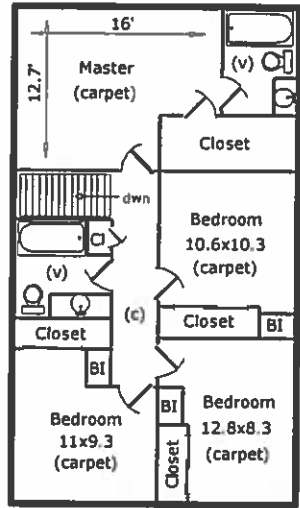
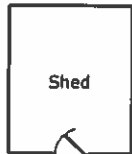

Second Floor  
926.9 sf

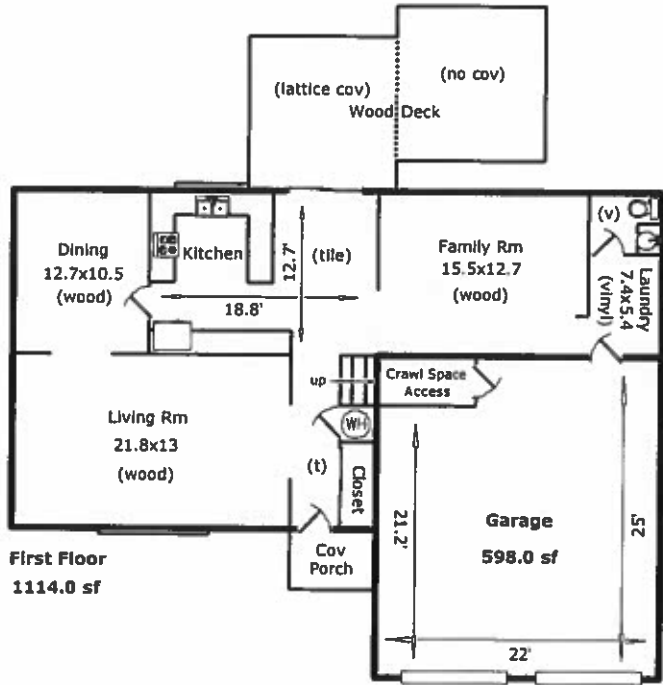

First Floor  
1114.0 sf