

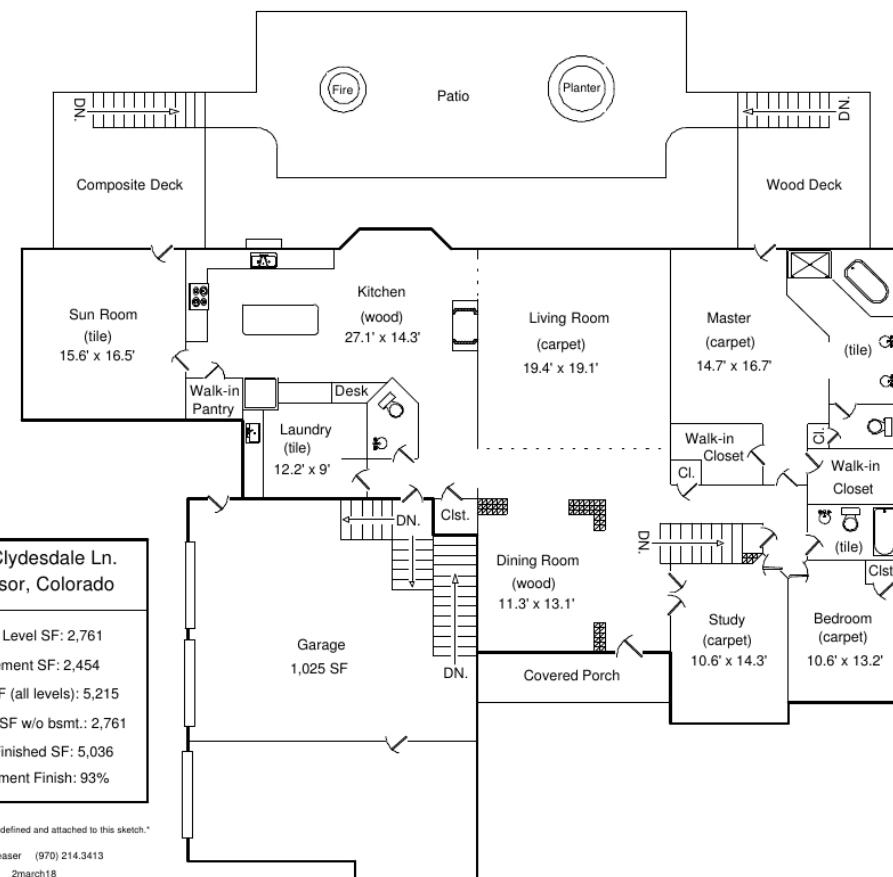

MLS # 851877
 Lot Size 108,900
 Approx Acres 2.5
 Electric PV REA
 Water Town of Windsor
 Gas Xcel Energy
 Taxes/Yr \$4,542/18
 HOA \$180/year
 Year Built 1998
 Bedrooms 6
 Bathrooms 5
 Subdivision .. Windsor Estates
 Style Ranch
 Construction ... Frame/Brick
 Floors Carpet, Wood, Tile
 Heating Forced Air
 Cooling Central A/C

Inclusions
 window coverings, electric oven,
 gas range, dishwasher,
 refrigerator, and clothes dryer

Schools
 Elementary Grandview
 Middle/Jr. Windsor
 High School Windsor
 District Windsor Re-4



**918 Clydesdale Ln.
 Windsor, Colorado**
 Main Level SF: 2,761
 Basement SF: 2,454
 Total SF (all levels): 5,215
 Finished SF w/o bsmt.: 2,761
 Total Finished SF: 5,036
 Basement Finish: 93%

Scope of Work is defined and attached to this sketch.
 Drew Geaser (970) 214.3413
 2march18

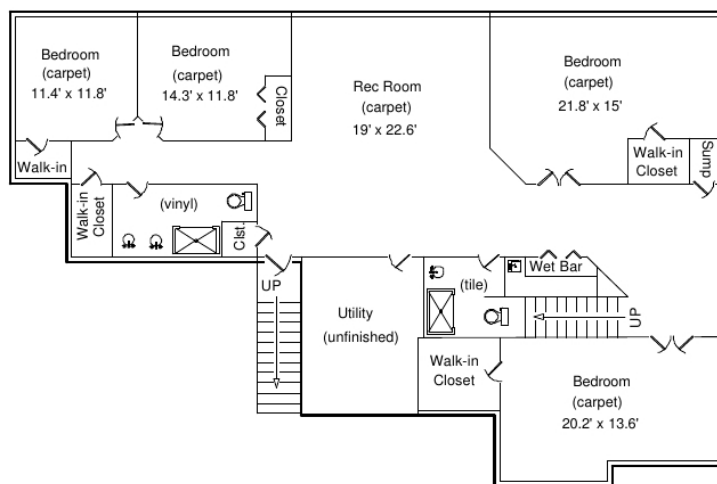

Sketch by Apex Sketch v5 Standard™

www.918Clydesdale.thegroupinc.com

Information herein deemed reliable but not guaranteed. Distance and measurements are approximate and subject to correction. See our listings at www.thegroupinc.com.



2.5 Acre Equestrian Lot!



918 Clydesdale Lane
Windsor

\$750,000

Kathy Beck

Broker Associate/Partner CSP, Eco
 (970) 213-8475 Cell
 (970) 229-2515 Direct
 (970) 229-0700 Office
kathy@kathybeck.com
www.kathybeck.com





Close in acreage with mountain views in desirable Windsor – equestrian lot and up to 900 sqft outbuilding allowed! Enjoy the bounty of numerous fruit trees including cherry, apricot, plum, apple, pear and peach, plus a large fenced gardening area. Separate entrance to the finished garden level basement creates a perfect suite arrangement – basement is fully finished with multiple bedrooms, large living area, two baths and a wet bar/kitchenette. Relax on one of two decks, or stay warm by the gas firepit on the back patio. Entertain easily in the country kitchen with beamed vaulted ceiling, sunroom with fireplace and spacious great room. Home warranty included for no worries!

Mountain Views - Outbuildings Allowed

