

1617 Cattail Drive, Loveland
\$340,000





Welcome Home!

Nicely updated ranch-style home, located in beautiful South-West Loveland. TONS of windows & lots of light throughout this open floor plan! On a large corner lot, this adorable home close to Cattail Pond has LOTS of updates to offer throughout. Stainless steel appliances, updated kitchen, bathrooms. French doors lead to office. Basement is 90%+ finished. Move-in ready! Home has been pre-inspected!

Total SF 2,386 sf
 Lot Size 8,051 sf
 HOA Fees None
 Electric City of LV
 Water City of LV
 Gas Xcel
 Taxes/Yr \$1,452/2017
 Bedrooms 4
 Bathrooms 3
 Garage 2 Car Attached
 Subdivision Cattail Pond
 Year Built 1993
 Style Ranch
 Construction Frame/Brick
 Heating Forced Air
 Cooling Central Air

Room Sizes

Kitchen 11x11
 Living Room 18x14
 Dining Room 10x08
 Family Room 24x18
 Master Bedroom 15x10
 Bedroom 2 11x09
 Bedroom 3 11x10
 Bedroom 4 11x10
 Study 13x10
 Laundry 06x05

Schools:

Elementary Carrie Martin
 Middle Walt Clark
 High School Thompson Valley
 District Thompson R2-J

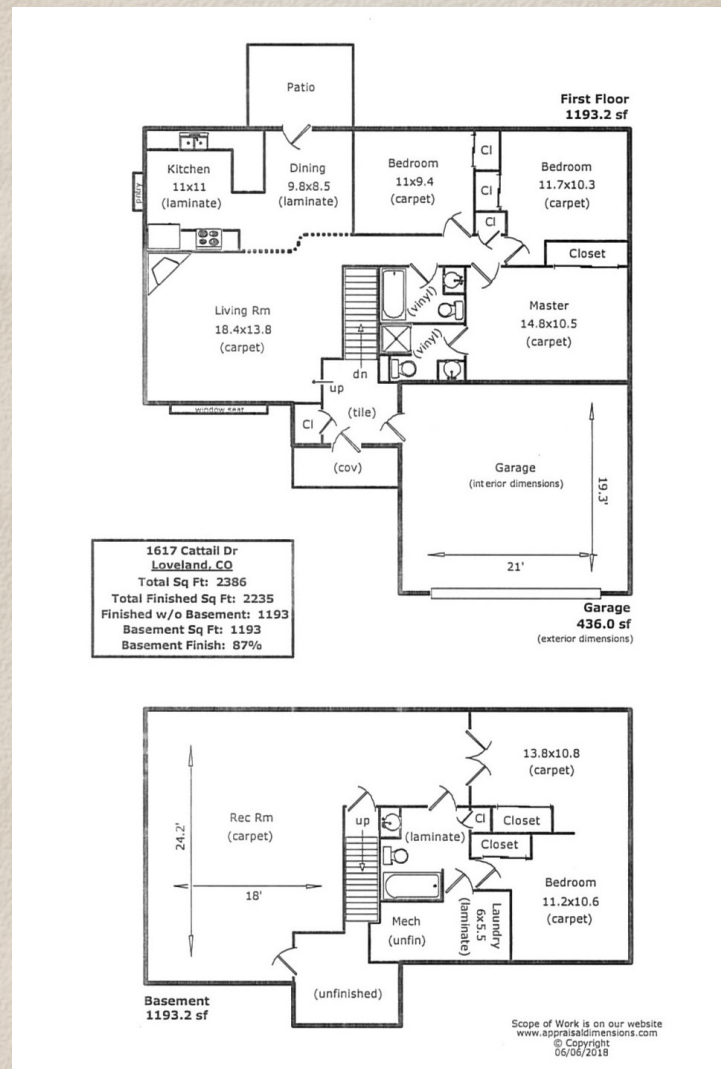

Mary Ann Michels

Broker Associate/Partner
 970-310-7944 Cell
 970-419-2341 Direct
 970-221-0700 Office
 mamichels@thegroupinc.com
 www.MichelsRealEstate.com



THE GROUP INC.
 Real Estate

