



2857 Sally Ann Drive

Loveland

\$329,900

Spacious 4 bed home on a peaceful cul-de-sac in a quiet neighborhood! Looking for privacy, this is the neighborhood for you. Great bi-level floor plan with large living areas. Lovingly cared for with newer furnace and A/C, roof, ext paint, tankless H2O heater, garage door opener and appliances. Large backyard with shed. Bonus sunroom to enjoy all seasons.



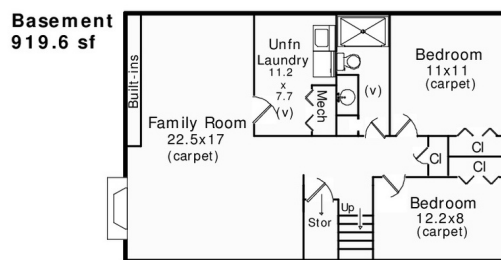
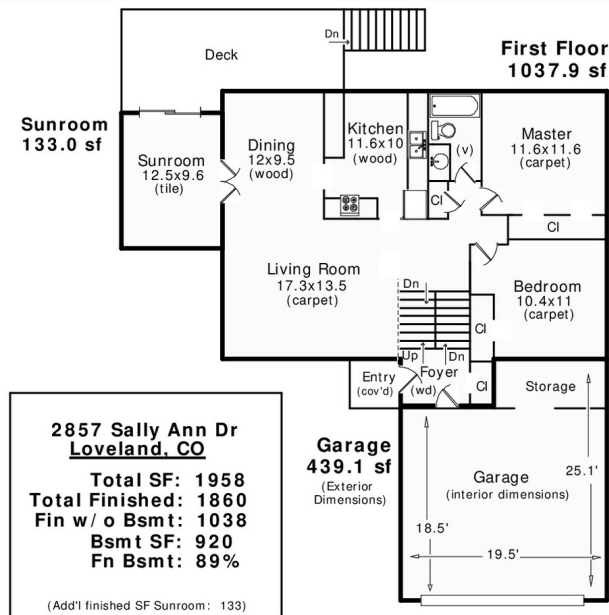

Information herein deemed reliable but not guaranteed. Distance and measurements are approximate and subject to correction. See our listings at www.thegroupinc.com.

GENERAL INFORMATION

MLS853177
 Electric City of Loveland
 Gas Xcel Energy
 Water City of Loveland
 Taxes/Yr .. \$1,337.47 / 2017
 Bedrooms 4
 Bathrooms 2
 Subdivision . Highland Knolls
 Style Bi-Level
 Construction ... Wood/Frame
 Floors ... Carpet,Wood,Vinyl
 Heating Forced Air
 Cooling Central A/C

INCLUSIONS

Window Coverings, Electric Range/Oven, Dishwasher, Refrigerator, Microwave, Washer, Dryer

SCHOOLS

Elementary Carrie Martin
 Middle/Jr. Clark (walt)
 High School Thompson Valley District
 District Thompson R2-j



Marketed by:
Seth Hanson
 Broker/Partner
 970-310-7498 Cell
 970-377-4955 Direct
 970-229-0700 Office
 shanson@thegroupinc.com
 www.liveinnoco.com

