



Popular Rocksbury Ridge!



358 Gypsum Lane Johnstown



Offered at
\$340,000

Joanne DeLeon

Broker Associate / Partner (970) 691-2501
(970) 229-0700 office | jdeleon@thegroupinc.com | www.joannedeleon.com



Lot Size 6,600
 Approx Acres 0.15
 Electric Xcel Energy
 Water Town of Johnstown
 Gas Xcel Energy
 Taxes/Yr \$1,757/17
 Bedrooms 4
 Bathrooms 3
 Subdivision Rocksbury Ridge
 HOA \$240.00/Year
 Year Built 2003
 Style 2-Story
 Construction Wood/Frame, Stone
 Floors Carpet, Vinyl
 Heating Forced Air
 Cooling Central A/C

Inclusions

Window Coverings, Electric Range/Oven,
 Dishwasher, Refrigerator, Microwave

Schools

Elementary Letford
 Elementary 2 Pioneer Ridge
 Middle/Jr. Milliken
 High School Roosevelt
 District Weld Re-5j

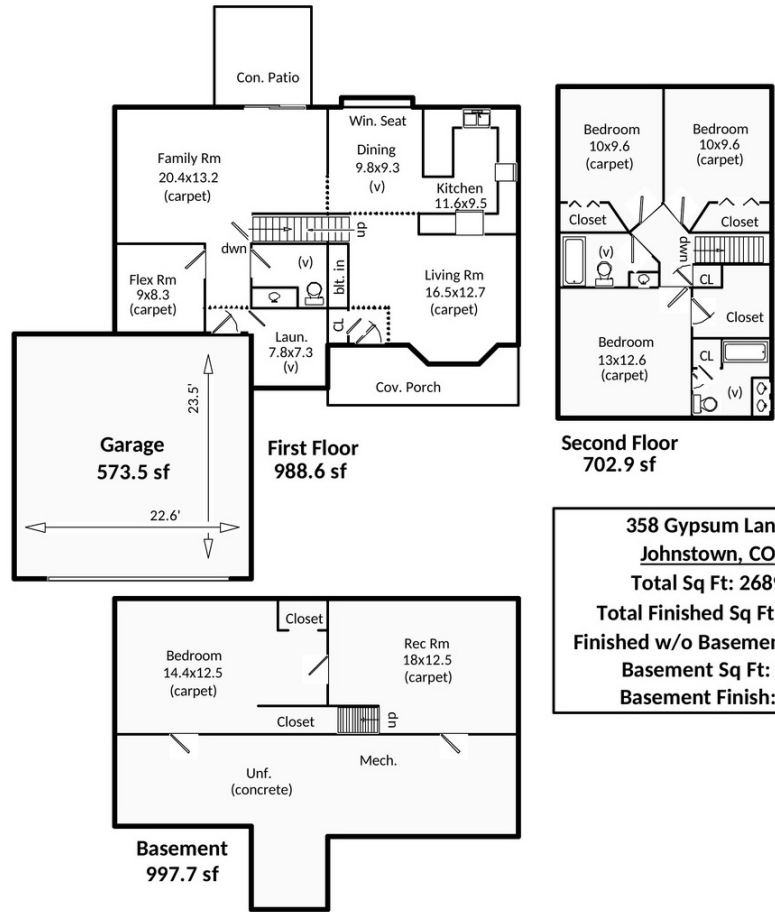

358 Gypsum Lane
Johnstown, CO
Total Sq Ft: 2689
Total Finished Sq Ft: 2235
Finished w/o Basement: 1691
Basement Sq Ft: 998
Basement Finish: 55%

Home Is Like New!

Roof/interior paint new w/transferable roof warranty. Carpet/main & upper is new & bsmt finished w/large rec room & bedroom. A bath can easily be the next addition! 4 bedrooms, 3 baths, and 2 car garage on a good sized lot (fully fenced back yard). Updated in and out! Living & family rm open to kitchen. Family room door to patio. Kitchen w/ample cabinets, window seat, eat-in & breakfast bar. Master bed w/full bath & walk-in closet. Other 2 beds are good size & share a full bath. Out the door to Johnstown Reservoir, parks and trails!

